

43 Power Street Islington NSW

3 1 1

Ideally positioned on a quiet corner location that provides the opportunity for access to the rear grounds. A traditional Islington home that features high ceiling, spacious bedrooms, a separate lounge and eat in kitchen. Whilst only a stones throw to Islington Park and Maitland Road the home enjoys a quiet sunny northern aspect.

Presented in original condition there is enormous scope to renovate immediately or over time.

The owner has committed to her new home so we are on the move.

Type : House

View : <https://www.street.net.au/sale/nsw/newcastle-region/islington/residential/house/7747546>

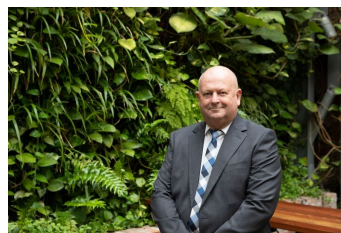

Andrew Walker
02 4926 3933

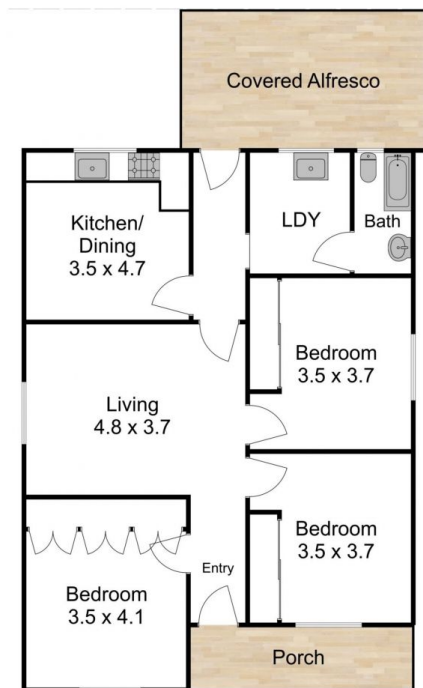

Site Plan

43 Power Street,
Islington

Measurements are approximate and are to be used as a guide only

Street
Property.