



3/44 Park Avenue Adamstown NSW

3 

Rare offering in a highly sought after area of Adamstown Hts are these commercial offices complete with parking.

Close to Westfield Kotara and busy retail precinct, these air-conditioned offices offer 5 rooms, a reception area, kitchen facilities, amenities and 3 parking bays and are disabled friendly.

Available soon.

Rental only \$2,150 plus GST per month plus a small contribution towards outgoings.

Contact Patrick Mitchell for further details.

Type : Industrial
Building Size : 100 sqm
View : <https://www.street.net.au/lease/nsw/new-castle-region/adamstown/commercial/industrial/8070524>



Patrick Mitchell
02 4926 3933

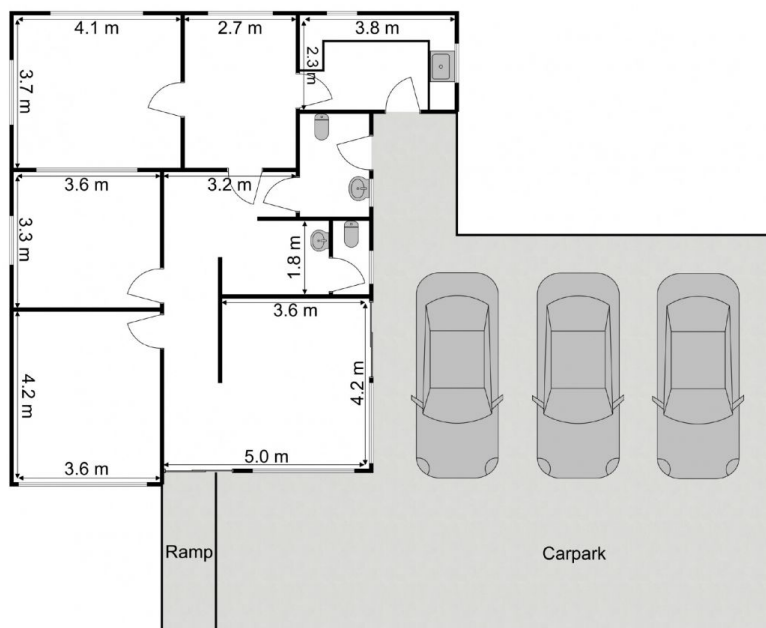

Internal Sqm: 100m² Approx.



3/44 Park Avenue,
Kotara

Measurements are approximate and are to be used as a guide only

Street
Property.